

Ignition switch

The ignition switch, on the right-hand side of the steering column, has four key positions:

- 0 __ ignition OFF
- I __ auxiliary
- II __ ignition ON
- III __ engine start

Position '0': is the only position in which the key can be inserted and removed.

Position 'I': allows use of some electrical circuits, for example, radio operation. The airbag system is activated in this position.

Position 'II': all electrical circuits except the starter motor are activated. The key remains in this position when driving.

Position 'III': the starter motor is operated.

To remove the ignition key:

Manual transmission vehicles only:

Apply the handbrake and turn the key to position '0'. The key can then be removed from the switch.

Automatic transmission vehicles only:

Automatic transmission vehicles have a key interlock feature.

Apply the handbrake, place the gear selector in 'P' and turn the key to position '0'.

The automatic transmission gear selector must be placed in Park 'P' before the key can be removed from the ignition switch. When the key is removed, the gear selector will be locked in Park.

Gear-shift interlock

A brake pedal/gear-shift interlock system is incorporated in the automatic transmission gear selector mechanism.

To move the gear selector from Park:

1. Turn the ignition key to position 'II' or start the engine.
2. Press the brake pedal.

Steering column lock

When the ignition key is removed from the ignition switch the steering column lock is engaged. The lock is disengaged when the key is inserted into the ignition switch and turned to position 'I'.

In rare circumstances it may be necessary to gently turn the steering wheel from side to side to release the steering column lock.

2-2 Security and locks

Vehicle security

When leaving the vehicle unoccupied, remember the following:

- Apply the handbrake and with automatic transmission, move the gear selector to Park 'P'.
- Do not leave children or pets in the vehicle unattended.
- Do not leave luggage or valuables on view. Always take your valuables with you or lock them in the luggage compartment.
- Remove the ignition key and spare keys, even when the vehicle is in your garage.
- Close all windows and lock all doors securely.
- Park the vehicle where it can be seen. At night, park in a well-lit area.
- When leaving the vehicle unattended, for maximum security ensure that the doors are double-locked.

Ensure that all keys and key transmitters are removed from the vehicle before locking the doors, and that all doors, the luggage compartment and the bonnet are closed.

It is important to keep your keys in safe places at all times. Leaving them in conspicuous places is an invitation for a thief to steal them and, consequently, your vehicle or belongings. Keep them as secure as you would your wallet or purse, both at home and away.

Immobilisation system security light

This vehicle is equipped with an immobilisation system.

An electronic device is fitted in the head of each key which is programmed to the vehicle electronics. When the key is placed in the ignition switch the vehicle electronics recognise the correct key and allow engine start. The engine cannot be started with a key not programmed to the vehicle electronic systems.

If an ignition key is placed in the ignition switch and turned to position 'II' and the alarm security light on the centre console remains flashing after three seconds, it is possible that the engine will not start. In any event, please contact a Jaguar Dealer to investigate the cause of the light flashing.

Keys

The key, which is integrated with the remote transmitter, operates all the locks on your vehicle.

Vehicles are supplied with two key transmitters.

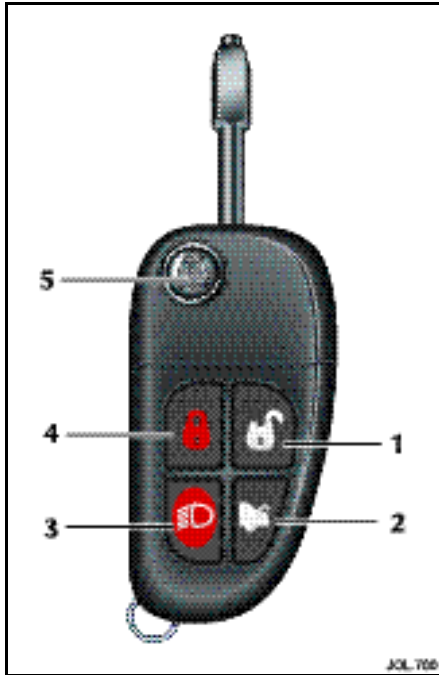

Key transmitter

The security system is controlled remotely by a radio frequency, battery-operated, integrated key transmitter.

The transmitter is activated by pressing one of the operating buttons.

1. Unlocks and disarms the vehicle.
2. Releases luggage compartment lock.
3. Activates the convenience headlamp feature and sounds the panic alarm.
4. Locks/double-locks and arms the vehicle.
5. Lock/unlock the key.

To free the key, press the release button (5). When not required press and hold the button and fold the key into the transmitter housing.

Note: Key transmitters will not operate if a key is in the ignition switch.

Each integrated key will operate the ignition switch and lock the doors.

The key number is recorded on a label which is attached to each key. Detach the label and keep safely, not in the vehicle.

Additional keys and key transmitters can be obtained from your Dealer and can be used provided a Dealer programmes them all to the vehicle.

Caution: Should a key or key transmitter be lost, a new one can be obtained and programmed to the vehicle by a Jaguar Dealer, who will ask for proof of vehicle ownership. It is advisable to notify a Dealer as soon as a key or key transmitter is lost or stolen and have the remaining key(s) or key transmitter(s) reprogrammed. This will then prevent the lost or stolen key/key transmitter from being used to disarm and unlock the vehicle.

Note: Dealers keep a log of all enquiries for replacement keys and notify Jaguar Cars Ltd. of any such requests.

Care of key transmitters

The key transmitters must be treated with care and not exposed to extremes of heat, dust, humidity or be in contact with fluids. Do not leave the transmitter exposed to direct sunlight.

The battery is the only serviceable part.

2-4 Security and locks

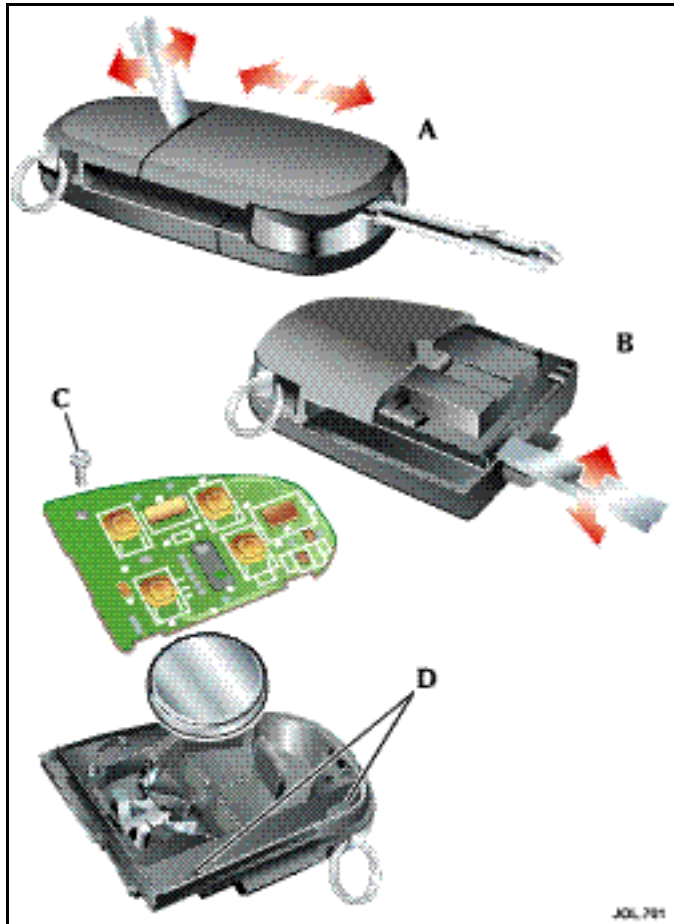

Key transmitter battery renewal

When the battery needs renewal there will be a significant decrease in the effective range of the key transmitter.

To renew the battery, using a small, flat-blade screwdriver, separate and pull the transmitter (A) from the key body. Insert the screwdriver into the groove between the covers (B) and, by twisting the screwdriver, prise the covers apart. Unscrew and remove the small screw (C) and remove the printed circuit board, taking care not to touch the battery terminals. Remove the battery and dispose of it safely. Fit a new cell, type CR2032, available from your Jaguar Dealer, with the side marked with the positive symbol (+) downwards in the battery receptacle. Avoid touching the new battery as moisture/oil from the fingers can reduce the life of the battery and corrode the contacts. Replace the printed circuit board making sure to engage the board under the securing tabs (D), and secure with the screw. Refit the cover and click into place with thumb pressure. Slide the transmitter back onto the key body.

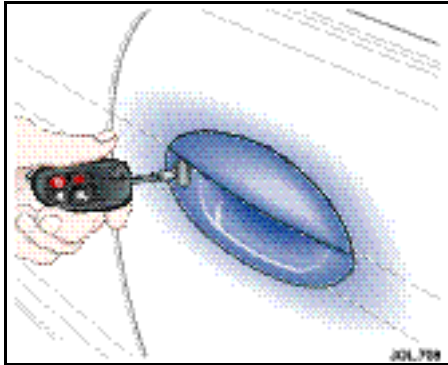

Door locks and handles

All doors can be locked and unlocked using a key transmitter or key.

Smart locking

This feature helps prevent locking the key in the vehicle. If one of the front doors is open and an attempt is made to lock the doors using a door interior locking lever, all doors will become unlocked.

If a door, bonnet or luggage compartment is open the vehicle can only be locked from the outside by using a key in the driver's door lock.

It will not be possible to lock the vehicle with a key transmitter if a door, luggage compartment or bonnet is open.

Vehicle locking and unlocking

To lock the vehicle and set alarm

- Press the lock button on the key transmitter, or
- Put the key in the driver's door lock, turn the key towards the rear of the vehicle and release.

The direction indicators will flash once, the security light on the centre console will start flashing and, after 20 seconds, the alarm will be set.

If a door, the bonnet or the luggage compartment lid are open and an attempt is made to lock the vehicle, the direction indicators will flash five times and the horn will chirp twice as a warning that the vehicle is not secure.

Note:

1. Ensure that the manually operated rear windows are closed.
2. If the vehicle is locked and the transmitter lock button is pressed, the horn will chirp once to confirm the vehicle is secure.

To unlock and disarm the vehicle Using a key transmitter

- Press the unlock button on the key transmitter.

This unlocks all doors and luggage compartment and turns on the interior lights. The direction indicators will flash five times if a fault exists with the intrusion sensing or inclination sensing systems.

Using a key

- Put the key in the driver's door lock, turn the key towards the front of the vehicle and release.

The exterior direction indicators give two flashes as unlocking takes place. Unlocking the vehicle turns on the interior lights.

European countries and United Kingdom only: If the vehicle is unlocked with a key when it is armed, a ticking sound will be heard when the driver's door is opened. This is a warning to indicate that the vehicle alarm will activate after 15 seconds unless the security system is disarmed by either pressing the unlock button on the key transmitter or by placing the key into the ignition switch and turning the key to position 'I'.

2-6 Security and locks

Note:

1. If a passenger door is opened during this period, before the vehicle is disarmed, the alarm will sound.
2. Unlocking with the key does not disarm the security system, this provides extra protection against vehicle theft.

For all other countries: unlocking the vehicle disarms the alarm system.

Global closing



WARNING:
Ensure that all occupants are kept clear of the windows and sunroof aperture.

Using the key in the driver's door, lock the vehicle and hold in this position to close all the electrically operated windows (and sunroof, if fitted).

Using a key transmitter, press and hold the lock button for longer than 1½ seconds to close all the electrically operated windows (and sunroof, if fitted). Pressing the lock button while global closing is taking place will cause all movement to stop.

Note: Manually operated rear windows will not global close. Ensure when locking the vehicle that the rear windows are fully closed.

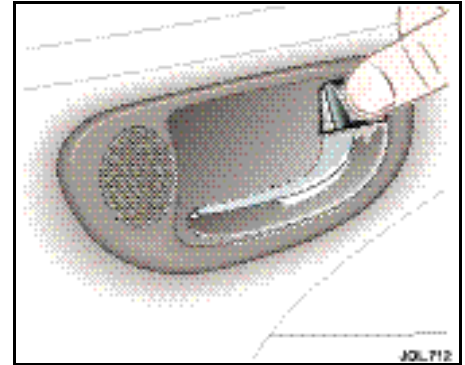

Internal door locking and unlocking

To centrally lock all doors, press the lock lever on the driver's or front passenger's door.

To lock a rear door, press the lock lever.

To unlock a front door, pull the release handle or the lock lever.

To unlock a rear door, pull the lock lever.

The driver's or front passenger's door lock lever will unlock all doors.

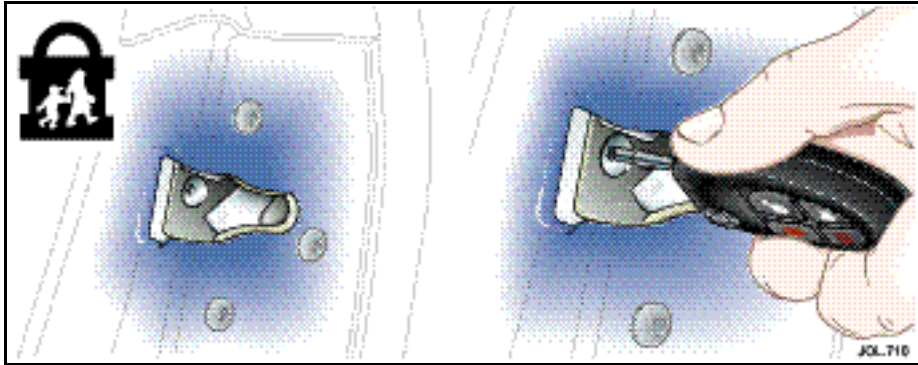

With all doors closed, press the lock button on the key transmitter twice within three seconds to double-lock the vehicle and set the alarm. Alternatively, place the key in the driver's door lock, turn the key towards the front of the vehicle and then towards the rear within three seconds.

The exterior direction indicators will flash, once as locking takes place and a longer, second flash as double-locking takes place.

Drive-away door locking

With the ignition key at position 'II' and all doors closed, all doors will lock when the vehicle is moving above 5 mph (8 km/h). If the vehicle is stopped and a door is opened, provided the engine remains running, the car will relock when the door is closed and the vehicle is moving. If the car is unlocked this feature will only lock the doors again if the ignition is turned off and then back on. All vehicles have the drive-away door locking feature installed during manufacture. This feature can be disabled, or reinstated, by a Jaguar Dealer, if required.

Child safety locks

Child safety locks are fitted to the rear doors.

Open a rear door, insert the ignition key into the lock and turn the key outwards. This immobilises that door interior handle. Repeat this for the opposite rear door.

After setting the child lock the door(s) can only be opened using the exterior door handle.

To remove the child lock feature, open the door and using a key, move the control to its original unlock position.

Double-locking



WARNING:
When the vehicle is double-locked the doors cannot be opened, either from inside or outside the vehicle, except with the correct key or key transmitter. Breaking a window will not allow a thief access by opening a door. Therefore, double-locking should not be used when persons are inside the vehicle as they will not be able to vacate, or be released from the vehicle if an emergency arises.

Note: It will not be possible to double-lock the vehicle if any door is open.

2-8 Security and locks

Auto-relocking

This feature automatically centrally locks and arms the vehicle if the vehicle has been unlocked with the key transmitter:

- and no door has been opened for 45 seconds or
- if the ignition remains off for 45 seconds.

This feature can be disabled, or reinstated, by a Jaguar Dealer, if required.

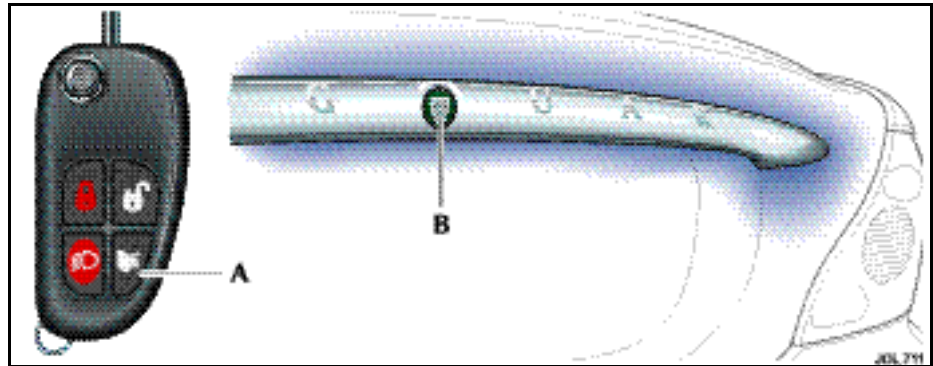

Luggage compartment

To open the luggage compartment:

- press the luggage compartment button (A) on the key transmitter or,
- with the vehicle unlocked, press the release button (B) on the compartment lid.

If the vehicle alarm system is armed and the luggage compartment is opened using the key transmitter the alarm will not sound. The system will be rearmed when the lid is closed, provided the vehicle has not been disarmed.

Alarms and audible signals

Note: In certain markets, legislation prohibits the use of audible confirmation signals. In such cases, the sound source has been removed from the system.

Audible signals

Two horn chirps will sound if an attempt is made to lock the vehicle with the key transmitter if a door, the bonnet or the luggage compartment is not fully closed.

European countries and United Kingdom only:

If the vehicle is unlocked with a key when it is armed, a ticking sound will be heard when the driver's door is opened. This is a warning to indicate that the vehicle alarm will activate after 15 seconds unless the security system is disarmed with either the key transmitter or by turning the ignition key to position '1'.

If the vehicle is unlocked with a key when it is armed and any door other than the driver's door is opened, the alarm will sound immediately.

Error signal

The direction indicators will flash five times whenever one of the following conditions is present:

- If any door is open when an attempt is made to lock the vehicle.
- The luggage compartment or the bonnet is not properly closed when an attempt is made to lock the vehicle.
- If there is an electrical failure within the intrusion sensing or inclination sensing systems and an attempt to 'disarm' the security system is made.

Full alarm

Once armed, any of the following circumstances will create a full alarm state, sound the horns and flash the direction indicators:

- Opening a door, luggage compartment lid (except with transmitter) or bonnet.
- Movement in the passenger area (if intrusion sensors are fitted).
- Using a key in the ignition switch which is not programmed to the vehicle.
- If, after 15 seconds from opening the driver's door with a key (European countries and United Kingdom only), the key is not inserted into the ignition switch.
- If the inclination sensor (if fitted) is activated.
- Any attempt is made to remove the radio.

2-10 Security and locks

Security features

The security system has been designed for:

- Prevention of theft of the vehicle
- Prevention of theft of items from the vehicle
- Personal security

The security system is integrated with the vehicle electronics and engine management systems making it far more difficult for a thief to penetrate and steal the vehicle.

Intrusion sensing

A further enhancement to the security system is the addition of intrusion sensing. When the vehicle is armed and double-locked, movement within the vehicle interior will activate the alarm. The luggage compartment can be unlocked, using the key transmitter button, without sounding the alarm. When the security system is disarmed the intrusion sensors are also disarmed.

Note: Ensure that manually operated rear windows are closed before double-locking the vehicle. This will prevent intrusion sensing falsely sounding the alarm.

Inclination (tilt) sensing protection

This feature protects against unauthorised towing away or jacking up. When the vehicle is double-locked and armed, any tilting of the vehicle, such as jacking or lifting, will activate the alarm.

Note: If the vehicle is being transported by road, rail or sea, the vehicle should not be double-locked. This prevents the inclination system from being armed and sounding the alarm as the vehicle pitches and rolls.

When the security system is disarmed the inclination sensor is also disarmed.

Battery reconnection

If the battery has been disconnected and is subsequently reconnected, the alarm system will resume the same state as before the battery was disconnected.

If the alarm was sounding when the battery was disconnected it will sound again when the battery is reconnected and will need the transmitter unlock button to be pressed or key placed in the ignition switch and turned to position 'I' to disarm it.

Panic alarm

When in or near the vehicle, the alarm can be set off to deter a possible offender. For this feature to operate, the key must not be in the ignition switch.

Pressing the headlamp convenience/panic button on the key transmitter three times within three seconds will activate the 'Panic Alarm'.

The alarm is stopped by:

- putting the key into the ignition switch and turning to position 'II' or
- pressing either the transmitter panic button three times or one press of the unlock button.

Battery back-up sounder

In certain markets a separate, self-contained, battery back-up sounder is fitted. This device will sound the full alarm if the vehicle alarm is activated or if the vehicle battery or the sounder is disconnected when the security system is armed.

Radio frequency approval

If the type approval of your key transmitter requires inspection, refer to the table below.

Type Exam. Certificate Number: CERT 980154-01

Country	Approval No.
Australia	
Austria	
Belgium	
Brazil	
Chile	
Czech Republic	
Finland	
France	
Germany	
Israel	
Italy	

Country	Approval No.
Korea	
Luxembourg	
Netherlands	
Norway	
Portugal	
South Africa	
Spain	
Sweden	
Switzerland	
Taiwan	
United Kingdom	



HomeLink® Universal Transceiver

The HomeLink Universal Transceiver is fitted in the roof console. HomeLink can be programmed to transmit the radio frequencies of up to three different transmitters used to activate garage doors, gates, home lighting, security systems, or other radio frequency operated devices.

If you would like additional information on the HomeLink Universal Transceiver, compatible products or to purchase other accessories such as the HomeLink lighting package, contact your Jaguar Dealer or Homelink on the internet at www.homelink.jci.com.



WARNING:

- 1. Do not use the HomeLink Universal Transceiver with any garage door opener that lacks the safety stop and reverse feature as required by safety standards. A garage door opener which cannot detect an object, signalling the door to stop and reverse, does not meet current federal safety standards. Using a garage door opener without these features increases risk of serious injury or death.**
- 2. When programming the HomeLink Universal Transceiver to a garage door opener or entry gate, make sure that people, the vehicle and objects are out of the way to prevent potential harm or damage as the gate or garage door will activate during the programme.**

Programming

Note: For best results, fit a new battery to the hand-held transmitter before programming. If your garage door opener receiver (located in the garage) is equipped with an antenna, ensure that the antenna is hanging straight down.

1. Switch off the engine.
2. Press and hold the two outermost buttons (1 and 3), releasing only when the indicator light begins to flash after 20 seconds.
Do not repeat this step when programming the additional buttons.
3. Hold the end of the hand-held transmitter of the device you wish to train approximately 1 to 3 inches (25 to 75 mm) away from the HomeLink surface, keeping the indicator light in view.
4. Using both hands, simultaneously push the hand-held transmitter button and the chosen HomeLink button (1, 2 or 3). The HomeLink indicator light will flash, first slowly and then rapidly. When the indicator light flashes rapidly, release both buttons. The rapid flashing light indicates successful programming of the frequency signal.

To programme the remaining buttons, follow steps 3 and 4.

Press and hold the programmed HomeLink button to activate the programmed device and release when the device begins to activate.

If, after 90 seconds, the indicator light does not flash rapidly, release both the Homelink and the hand-held transmitter buttons and repeat the procedure starting with Step 2. However, position the hand-held transmitter at a different angle and/or distance.

If the device does not operate you may need to complete the steps outlined in “Rolling code programming”.

Some entry gates and garage door openers may require you to replace Step 4 with the procedures in the section “Canadian Programming”.

If you are programming a rolling code equipped device, continue with the procedures outlined in “Rolling code programming”.

Note: Keep the original transmitter for future use or programming procedures if, for example, you purchase a new vehicle.

Caution: It is recommended that when you sell or dispose of the vehicle, the programmed Homelink buttons be erased for security purposes.

Canadian programming/Gate programming.

Canadian frequency laws, and the technology of some entry gates, require you to press and re-press (cycle) the hand-held transmitter button every two seconds during programming.

Continue to press and hold the desired Homelink button while you cycle your hand-held transmitter until the indicator light flashes rapidly.

Note: When programming a garage door opener or entry gate, unplug the device during the “cycling” process to prevent possible motor failure.

Rolling code programming.

Rolling code garage door openers (or other rolling code devices) which are “code protected” may be determined by the following:

- reference the device owner’s instruction manual for verification.
- the hand-held transmitter appears to programme the HomeLink Universal Transceiver but does not activate the garage door.
- press and hold the trained HomeLink button. The device has the rolling code feature if the HomeLink indicator light flashes rapidly and then turns solid after two seconds.

To train a garage door opener or other device with the rolling code feature, follow these steps after completing the Programming section instructions.

2-14 Security and locks

Note: The aid of a second person may make the following training procedures quicker and easier.

1. Locate the training button on the garage door opener receiver in the garage. Exact location and colour of the button may vary by garage door opener brand. If there is difficulty locating this button, reference the garage door opener instruction manual or contact HomeLink.

Note: Following step 2 there are 30 seconds in which to initiate step 3.

2. Firmly press and release the training button on the garage door opener receiver which will activate the training light.
3. Firmly press and release the HomeLink button. Press and release the HomeLink button a second time to complete the training process. Some garage door openers may require you to do this step a third time to complete the training.

The device should now recognise the HomeLink signal and activate when the HomeLink button is pressed.

The remaining buttons may now be programmed if this has not been previously done.

Reprogramming a HomeLink button

To programme a device to HomeLink using a button previously trained, follow these steps;

1. Press and hold the desired HomeLink button. Do not release until step 4 has been completed.
2. When the indicator light begins to flash slowly (after 20 seconds), position the hand-held transmitter 1 to 3 inches (25 to 75 mm) away from the HomeLink surface.
3. Press and hold the hand-held transmitter button.
4. The HomeLink indicator light will flash, first slowly and then rapidly. When the indicator light begins to flash rapidly, release both buttons.

The previous device has now been erased and the new device can be activated by pushing the HomeLink button that has just been programmed. This procedure will not affect any other programmed HomeLink buttons.

Erasing programmed HomeLink buttons.

Individual buttons cannot be erased, however, to erase all three programmed buttons:

1. Press and hold the two outermost buttons until the indicator light begins to flash after 20 seconds.
2. Release both buttons.

The HomeLink Universal Transceiver is now in the train, or learning, mode and can be programmed at any time following steps 3 and 4 in the “Programming” section.



WARNING:

The manufacturer is not responsible for any radio or TV interference caused by unauthorised modifications to this equipment. Such modifications could void the user's authority to operate the equipment.